

LCA Series ADJUSTABLE FLOW MONITOR

Low Cost Monitoring of Corrosive Liquid Flows

KEY FEATURES

Economical, Best for loss of flow detection, Normal flow to set point is 10:1 or greater.

APPLICATIONS

- Machine Lubrication
- Process Flows
- Cooling Systems
- Water Treatment Systems

FEATURES

- Adjustable
- Confirms: Normal flow conditions
- Senses: high flow or low flow conditions
- Output: Switch Contact

OPERATION

When flow is increased, the magnetic piston is forced against a bias spring. As the magnet comes near the adjustable reed switch it actuates, indicating proper flow. When flow decreases the spring forces the piston in the opposite direction deactuating the reed switch an indicating a reduced or no flow situation.

- All models field adjustable
- Deactuation (decreasing flow) averages 40% less than actuation (increasing flow).
- Repeatability $\pm 2\%$
- Correction must be made for attitudes other than horizontal.
- Unit will pass greater flows.

Corrections must be made for other liquids, line pressure and temperatures. Please consult your representative or the factory.



CALIBRATION RANGE

MODEL	ADJUSTABLE RANGE Increasing Flow Water LPM (GPM)	FACTORY PRESET FOR Decreasing Flow Water LPM (GPM)*	INLET/ OUTLET FNPT Port Inches
LCA-250	0.38 - 15.1 (0.10-4.00)	-10 0.38 (0.10) -20 9.46 (2.50) -30 11.46 (3.00)	1/4"
LCA-375	1.89 - 15.1 (0.50 - 4.00)	-10 1.89 (0.50) -20 9.46 (2.50) -30 11.36 (3.00)	3/8"
LCA-500	1.89 - 37.9 (0.50 - 10.00)	-10 1.89 (0.50) -20 18.93 (5.00) -30 28.39 (7.50)	1/2"
LCA-750	3.79 - 56.8 (1.00 - 15.00)	-10 3.79 (1.00) -20 18.93 (5.00) -30 28.39 (7.50)	3/4"

*-00 Available on all models - no settings

SPECIFICATIONS

MODEL	WEIGHT Lbs. (Kg)	MAX WORKING PRESSURE PSIG (barg)	WETTED PARTS
LCA 250P	.375 (.17)	100 (6.89)	PVC, Epoxy, 316SS
LCA-250-B	1.4 (.635)	1500 (103.42)	Brass, Epoxy, 316SS
LCA-250-S	1.4 (.635)	3000 (206.84)	316SS, Epoxy
LCA 375P	.375 (.17)	100 (6.89)	PVC, Epoxy, 316SS
LCA-375-B	1.4 (.635)	1500 (103.42)	Brass, Epoxy, 316SS
LCA-375-S	1.4 (.635)	3000 (206.84)	316SS, Epoxy
LCA 500P	.375 (.17)	100 (6.89)	PVC, Epoxy, 316SS
LCA-500-B	1.4 (.635)	1500 (103.42)	Brass, Epoxy, 316SS
LCA-500-S	1.4 (.635)	3000 (206.84)	316SS, Epoxy
LCA 750P	.625 (.283)	100 (6.89)	PVC, Epoxy, 316SS
LCA-750-B	1.7 (.771)	1500 (103.42)	Brass, Epoxy, 316SS
LCA-750-S	1.7 (.771)	3000 (206.84)	316SS, Epoxy

PRESSURE LOSS TABLE

MODEL	WATER FLOW RATE LPM (GPM)	ΔP BARD (PSID)
LCA-250/375		
Minimum	0.38 (0.10)	0.34 (0.5)
Maximum	15.14 (4.0)	0.21 (3.0)
LCA-500		
Minimum	1.89 (0.5)	0.069 (1.0)
Maximum	37.85 (10.0)	0.689 (10.0)
LCA-750		
Minimum	3.79 (1.0)	0.10 (1.5)
Maximum	56.8 (15.0)	0.62 (9.0)

TEMPERATURE OPERATING RANGE

- PVC: 32° to 120° F
- 316SS and Brass: 32 to 220° F
- Acrylic: 32 to 160° F

For other temperature ranges consult factory.

CE Recognized 73/23/EEC/93/68/EEC

Recognized File E75356

LCA Series ADJUSTABLE FLOW MONITOR

Low Cost Monitoring of Corrosive Liquid Flows

SWITCH DATA	SPST	SPDT
Maximum Switching Voltage		
DC (V)	200	175
AC (V)	150	120
Contact Rating		
DC (W)	50	5
AC (VA)	70	5
Maximum Switching Current (A)		
DC (A)	1.0	.25
AC (A)	0.7	.25

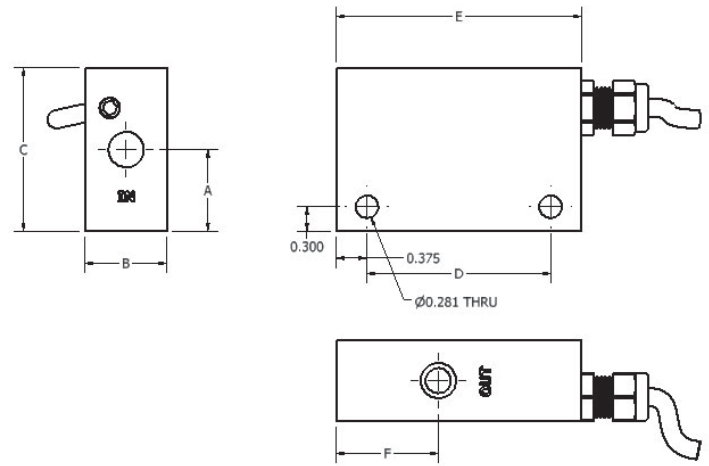

LEADS	SPST	SPDT (optional)
-------	------	-----------------

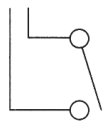

leads 18 in. min. from body 22 AWG, TFE insulation

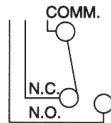

leads 18 in. min. from body 24 AWG, TFE insulation
 • green - N.O.
 • red - N.C.
 • black - Common

INSTALLATION

Mount with the inlet port on the side horizontally. Other attitudes change the adjustable range of the unit. A 100 micron filter is recommended.

Above values for resistive loads only. For inductive loads, surge current and rush current contact protection is required, consult your local representative. SPDT UL Recognized (E47258).

DIMENSIONS

Model	A	B	C	D	E	F
LCA-250	1.00 (25.4)	1.00 (25.4)	2.00 (50.8)	2.25 (57.15)	3.0 (76.2)	1.25 (31.8)
LCA-375	1.00 (25.4)	1.00 (25.4)	2.00 (50.8)	2.25 (57.15)	3.0 (76.2)	1.25 (31.8)
LCA-500	1.00 (25.4)	1.00 (25.4)	2.00 (50.8)	2.25 (57.15)	3.0 (76.2)	1.25 (31.8)
LCA-750	1.63 (41.4)	1.25 (31.8)	2.75 (69.9)	3.25 (82.55)	4.0 (101.6)	1.63 (41.4)

HOW TO ORDER (Sales@ChemTec.com | (800) 222-2177)

Model	Size	Materials	Factory Pre-set Options	Type of Service	Switch Options
LCA	250 375 500 750	P PVC A Acrylic B Brass S 316SS	-00, -10, -20, -30 (See Flow Settings)	W- Water	N.C. Normally Closed N.O. Normally Open SPDT Single Pole Double Throw

©Copyright 2012 V.1

*Consult Factory
 *Viton - E.I. Dupont & Co
 *Teflon - E.I. Dupont & Co
 *Kalrez - E.I. Dupont & Co

Note: All dimensions and specifications are subject to change for quality improvement. Not responsible for printing errors.

